



WESTSIDE SHOPPING CENTRE

Prime retail unit to let in
Galway City

20
22



Prime retail unit To Let

Westside Shopping Centre is located 1 km north-west of Galway city centre, within easy walking distance of both the University of Galway and Galway University Hospital.

The prominent **1,630 sq. ft** retail unit benefits from high footfall and passing traffic.

Anchored by Dunnes Stores with other tenants including a McDonalds Drive Thru, Boylesports, O'Hehirs Bakery, Mc Sharry's Pharmacy, RSA Driving Test Centre and Maxol.

Ample parking.



Location

Westside Shopping Centre is situated in a densely populated area on a main approach road to Galway city centre.

Nearby destinations include, the University of Galway, Galway University Hospital and Westside Business Centre.

Easily accessible via all city centre bus routes: 402, 404, 405, 411, 412.





Population of 137,857 people in the greater Galway city catchment area.

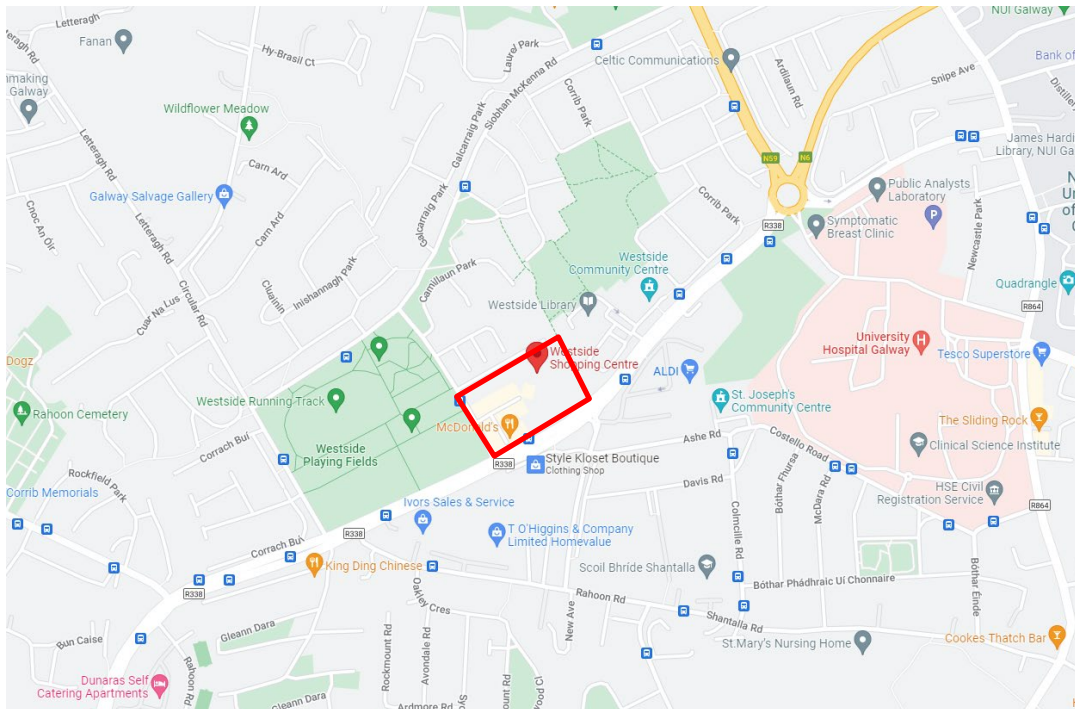

University College Galway (NUIG)



Connectivity / Travel Times

| |  |  |  |  |
|----------------------------|--|---|--|---|
| University of Galway | 16 mins | 10 mins | 5 mins | 6 mins |
| Eyre Square | 30 mins | 20 mins | 12 mins | 9 mins |
| University Hospital Galway | 11 mins | 7 mins | 4 mins | 4 mins |
| Salthill Promenade | 30 mins | 26 mins | 11 mins | 8 mins |
| Galway Train Station | 33 mins | 13 mins | 11 mins | 10 mins |
| Galway Coach Station | 33 mins | 12 mins | 13 mins | 9 mins |

Location map



 Bus Stops

Details

Lease

New Lease Available

Rent

On Application

BER

BER C1

Rates

For 2022: Approx. € 9,436.13

Unit 5 - Specification

 Total floor area 151.43 sq. m
(1,630 sq. ft)

Floor map

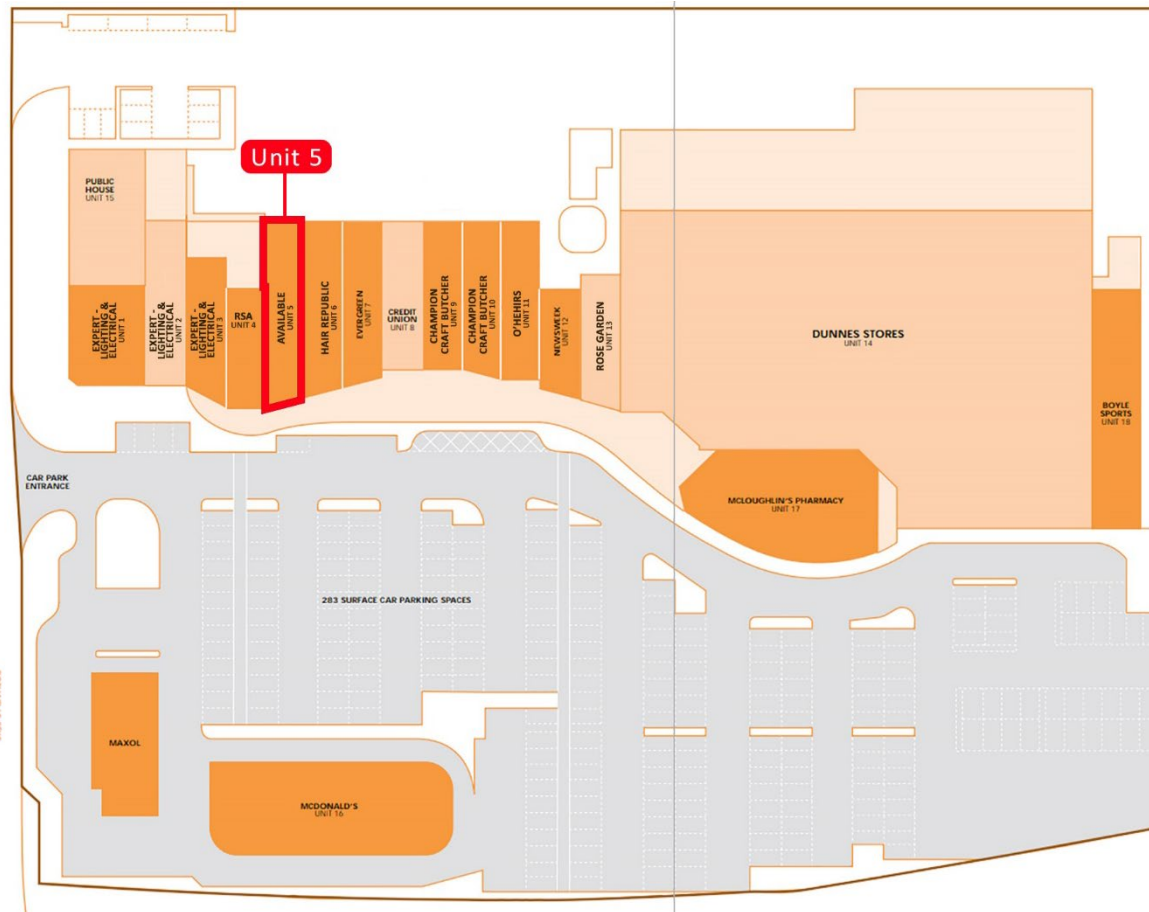
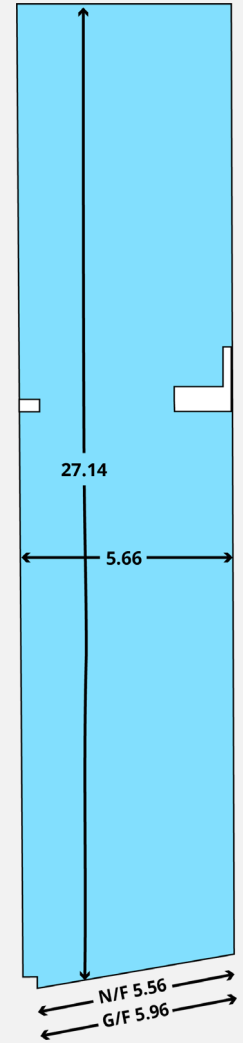

Westside Shopping Centre



CONTACT



19 – 26 Pembroke Street Lower, Dublin 2
T: + 353 (0) 1647-7900

DARREN PEAVOY

PSR: 001830-002141

T: +353 1 6477918

E: dpeavoy@bannon.ie

Disclaimer

These particulars are issued by Bannon on the understanding that any negotiations relating to the property are conducted through them. While every care is taken in preparing them, Bannon, for themselves and for the vendor/lessor whose agents they are, give notice that: (a) The particulars are set out as a general outline for guiding potential purchasers/ tenants and do not constitute any part of an offer or contract. (b) Any representation including descriptions, dimensions, references to condition, permissions or licences for uses or occupation, access and any other details are given in good faith and are believed to be correct, but any intending purchaser or tenant should not rely on them as statements or representations of fact but must satisfy themselves (at their own expense) as to their correctness. (c) Neither Bannon nor any of its employees have any authority to make or give any representations or warranty in relation to the property. All maps are produced by permission of the Ordnance Survey Ireland Licence No. AU00470011 - Government of Ireland. PSRA Licence No. 001830